

The Turret Interior



661: The graticules at the forward end of the gun sight could be illuminated by a plug-in lamp unit. This lamp unit was also fitted with a dimmer switch and was powered by a plug from the 12V socket attached to the turret roof above the gun sight mount.



663: A view of the **Bosch** 12V socket seen in photo **661**. This was named, **Steckdose für Strichplattenbeleuchtung**, and two of these were fixed to the turret roof. These sockets powered the gun sight graticule light and the main gun firing circuit



664: Fitted into the turret roof was an extractor fan that was used to exhaust fumes from the turret after firings of the main gun. This fan, the **Aufbaulüfter**, had an airflow extraction of 12 ³/min.



662: Of primary interest in this photo is the large spring balance cylinder seen at **1**. When the loader closed his hatch the arm at **2**, page **161**, illustration **667**, contacted the end plate, at **2**, thus allowing the damper spring to slow the closing of the hatch.

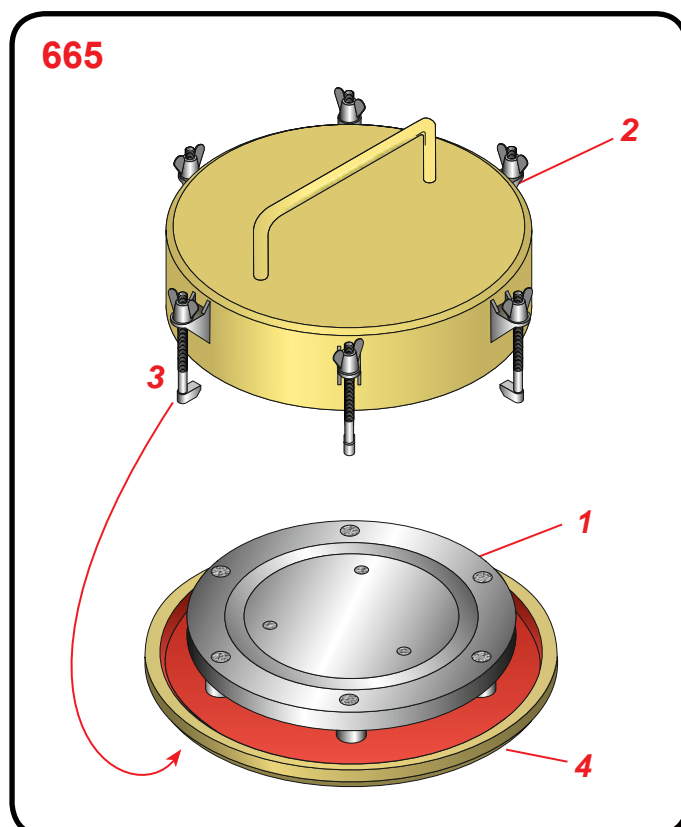

665: Covering the port in the turret roof over the extractor fan was an armoured plate, the **Panzerscheibe**, at **1**. For deep fording operations a cover, **Haube**, at **2**, could be screwed down over this port with the clamps at **3** locking the cover down under the flange at **4**.